

## 131A - Steel Stillson models

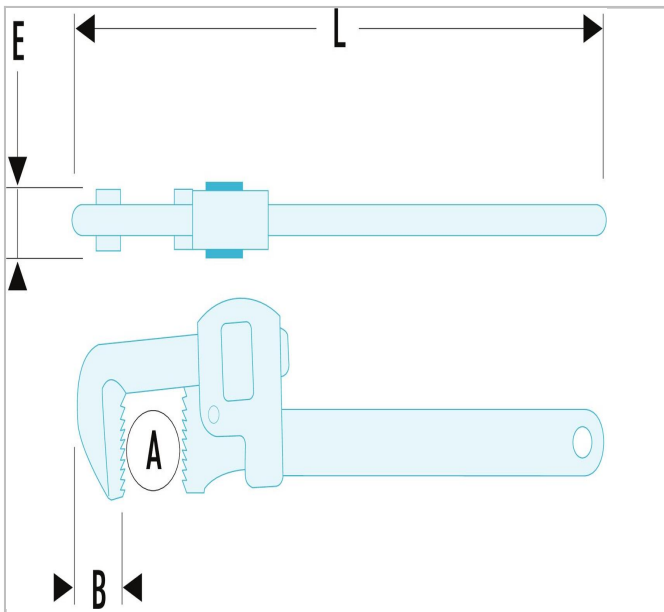

### Description:

- Capacity: 0 to 102 mm; 0 to 3"1/2.
- Very robust wrench, head hardened to 55 HRc.
- Accurate approach thanks to fine machining of the threads and button, good grip.





**131A.10**

**131A.14**

**131A.18**

**131A.24**

**131A.36**

**131A.8**